

28.2 AWAFLX (HOT ASPHALT APPLIED)

**Material Requirements**

TAMKO BASE-N-PLY <sup>®</sup> Fiberglass Sheet	1 ply
TAMKO AWAFLX <sup>®</sup>	1 ply
Asphalt (Per 100 sq. ft.)	Approx. 46 lbs.

**Slope:** Positive drainage up to 3 in. per linear ft. For slopes above 3/4 in. per linear ft., fastening of the AWAFLX membrane is required.

**Deck:** The deck should conform to TAMKO general requirements.

**Insulation:** The insulation should be installed according to the manufacturer's specification in the thickness required. The insulation should conform to TAMKO requirements. Polyisocyanurate and expanded polystyrene must have an overlay of a minimum 1/2 in. fiberboard, perlite, or fiberglass roof insulation.

**Asphalt:** The asphalt should be certified by the manufacturer to meet ASTM D-312, **Type III for slopes up to 1/4 in.** and **Type IV for slopes up to 3 in.**

**Base Ply:** Starting at the low point of the roof, install 1 layer of BASE-N-PLY beginning with a 1/2 m width, then a full 1 m width, side lapped 2 in. and end lapped 4 in. Apply at a right angle to the slope of the roof. Solid mop to the insulation with approximately 23 lbs. (±15%) of specification asphalt per 100 sq. ft.

**AWAFLX:** Starting at the low point of the roof, install 1 layer of TAMKO AWAFLX granule surfaced sheet, side lapped 3 in. and end lapped 6 in. The AWAFLX should be solidly adhered to the base ply (pressed into the hot asphalt) with approximately 23 lbs. (±15%) of specification asphalt per 100 sq. ft. The asphalt should be above 400° F at the point of application and mopped no more than 4 ft. in front of the roll.

**Flashing:** The flashing material **must** be a TAMKO polyester reinforced modified asphalt flashing material.

**U.L. Requirements:**  
Contact TAMKO for information on U.L. systems requirements.

**CAUTION:** The National Institute for Occupational Safety and Health (NIOSH) has concluded that fumes of heated asphalt are a potential occupational carcinogen. Apply heat to these products only when required for proper application and only in a well ventilated area. Avoid breathing the fumes, and avoid skin contact. Do not burn these products.

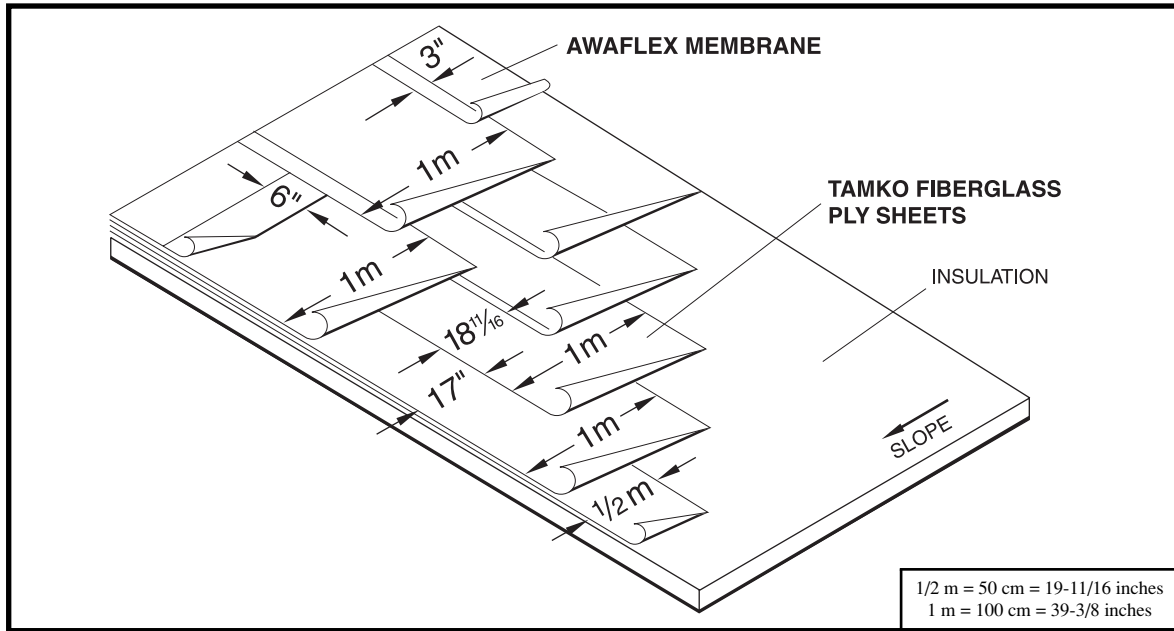

**Material Requirements**

TAMKO TAM-GLASS PREMIUM® or TAM-PLY IV® Fiberglass Ply Sheet	2 plies
TAMKO AWAFLX® (Granule Surfaced)	1 ply
Asphalt (Per 100 sq. ft.)	Approx. 69 lbs.

**Slope:** Positive drainage up to 3 in. per linear ft. For slopes above 3/4 in. per linear ft., fastening of the AWAFLX membrane is required.

**Deck:** The deck should conform to TAMKO general requirements.

**Insulation:** The insulation should be installed according to the manufacturer's specification in the thickness required. The insulation should conform to TAMKO requirements. Polyisocyanurate and expanded polystyrene must have an overlay of a minimum 1/2 in. fiberboard, perlite, or fiberglass roof insulation.

**Asphalt:** The asphalt should be certified by the manufacturer to meet ASTM D-312, Type III for slopes up to 1/4 in. and Type IV for slopes up to 3 in.

**Fiberglass Ply Sheet 2 Ply Installation:** Over the insulation, install 2 plies of TAM-GLASS PREMIUM or TAM-PLY IV in specification asphalt. Starting from the low point of the roof, apply a 1/2 m width, then a full 1 m width. Follow with full 1 m widths, shingle fashion, lapping each ply 20-11/16 in. in such a manner so that at least 2 plies cover the insulation at any one point. Approximately 23 lbs. (±15%) of specification asphalt per 100 sq. ft. should be used to embed each ply.

**AWAFLX:** Starting at the low point of the roof, install 1 layer of TAMKO AWAFLX granule surfaced sheet, side lapped 3 in. and end lapped 6 in. The AWAFLX should be solidly adhered to the ply sheet (pressed into the hot asphalt) with approximately 23 lbs. (±15%) of specification asphalt per 100 sq. ft. The asphalt should be above 400° F at the point of application and mopped no more than 4 ft. in front of the roll.

**Flashing:** The flashing material must be a TAMKO polyester reinforced modified asphalt flashing material.

**U.L. Requirements:**  
Contact TAMKO for information on U.L. systems requirements.

**CAUTION:** The National Institute for Occupational Safety and Health (NIOSH) has concluded that fumes of heated asphalt are a potential occupational carcinogen. Apply heat to these products only when required for proper application and only in a well ventilated area. Avoid breathing the fumes, and avoid skin contact. Do not burn these products.

28.2 AWAFLX  
(HOT ASPHALT APPLIED)

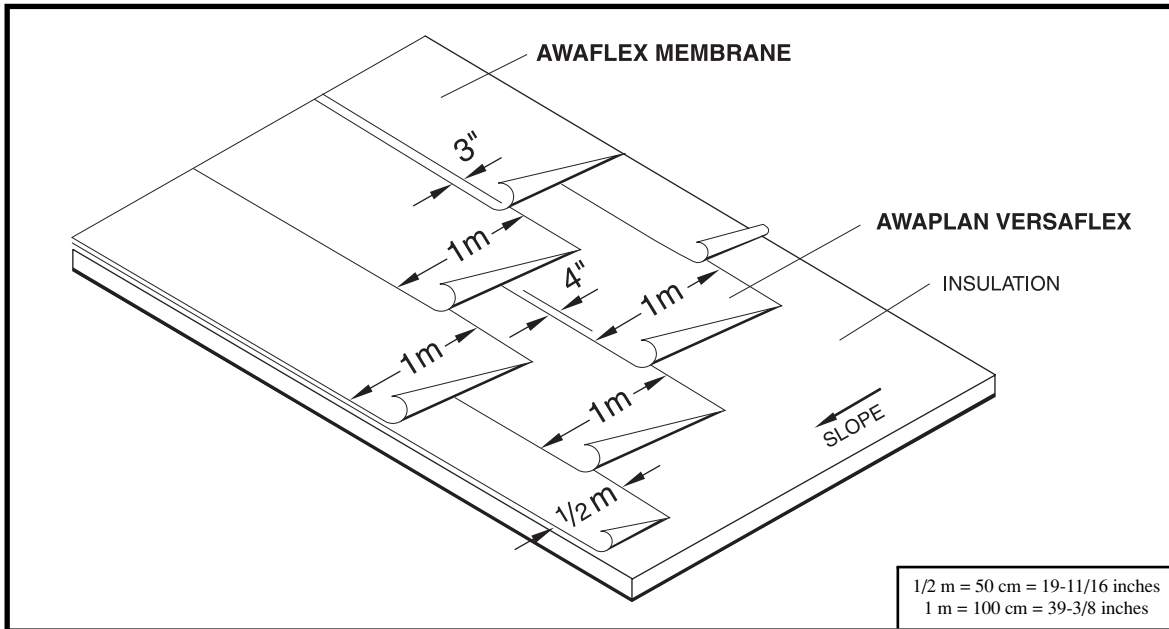

28.2 AWAFLEX (HOT ASPHALT APPLIED)

**Material Requirements**

TAMKO AWAPLAN VERSAFLEX	1 ply
TAMKO AWAFLEX <sup>®</sup>	1 ply
Asphalt (Per 100 sq. ft.)	Approx. 46 lbs.

**Slope:** Positive drainage up to 3 in. per linear ft. For slopes above 3/4 in. per linear ft., fastening of the AWAFLEX membrane is required.

**Deck:** The deck should conform to TAMKO general requirements.

**Insulation:** The insulation should be installed according to the manufacturer's specification in the thickness required. The insulation should conform to TAMKO requirements. Polyisocyanurate and expanded polystyrene must have an overlay of a minimum 1/2 in. fiberboard, perlite, or fiberglass roof insulation.

**Asphalt:** The asphalt should be certified by the manufacturer to meet ASTM D-312, **Type III for slopes up to 1/4 in.** and **Type IV for slopes up to 3 in.**

**AWAPLAN VERSAFLEX:** Over the insulation, install 1 ply of AWAPLAN VERSAFLEX in specification asphalt. Starting at the low point of the roof, apply the AWAPLAN VERSAFLEX beginning with a 1/2 m width, then a full 1 m width, side lapped 4 in. and end lapped 6 in. Apply at a right angle to the slope of the roof. The AWAPLAN VERSAFLEX should be solidly adhered to the insulation (pressed into the hot asphalt) with approximately 23 lb. (±15%) of specification asphalt per 100 sq. ft. The asphalt should be above 400° F at the point of application and mopped no more than 4 ft. in front of the roll.

**AWAFLEX:** Starting at the low point of the roof, install 1 layer of TAMKO AWAFLEX granule surfaced sheet, side lapped 3 in. and end lapped 6 in. The AWAFLEX should be solidly adhered to the base ply (pressed into the hot asphalt) with approximately 23 lbs. (±15%) of specification asphalt per 100 sq. ft. The asphalt should be above 400° F at the point of application and mopped no more than 4 ft. in front of the roll.

**Flashing:** The flashing material **must** be a TAMKO polyester reinforced modified asphalt flashing material.

**U.L. Requirements:** Contact TAMKO for information on U.L. systems requirements.

**CAUTION:** The National Institute for Occupational Safety and Health (NIOSH) has concluded that fumes of heated asphalt are a potential occupational carcinogen. Apply heat to these products only when required for proper application and only in a well ventilated area. Avoid breathing the fumes, and avoid skin contact. Do not burn these products.

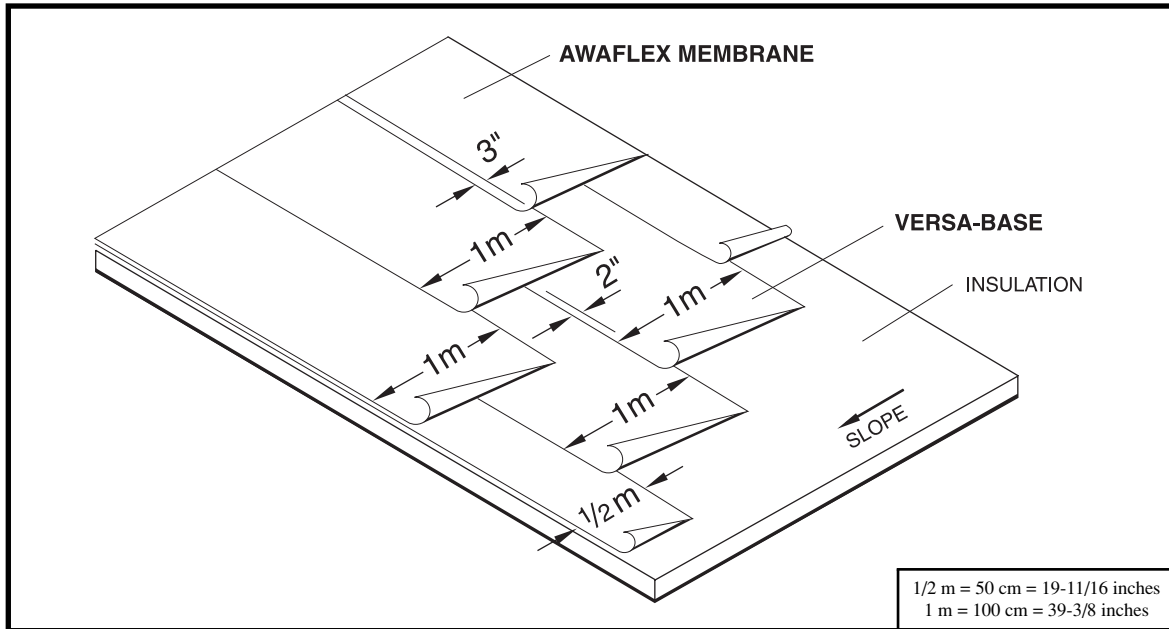

**Material Requirements**

TAMKO VERSABASE <sup>®</sup> Modified Asphalt Base Sheet	1 ply
TAMKO AWAFLX <sup>®</sup> FR	1 ply
Asphalt (Per 100 sq. ft.)	Approx. 46 lbs.

**Slope:** Positive drainage up to 3 in. per linear ft. For slopes above 3/4 in. per linear ft., fastening of the AWAFLX membrane is required.

**Deck:** The deck should conform to TAMKO general requirements.

**Insulation:** The insulation should be installed according to the manufacturer's specification in the thickness required. The insulation should conform to TAMKO requirements. Polyisocyanurate and expanded polystyrene must have an overlay of a minimum 1/2 in. fiberboard, perlite, or fiberglass roof insulation.

**Asphalt:** The asphalt should be certified by the manufacturer to meet ASTM D-312, Type III for slopes up to 1/4 in. and Type IV for slopes up to 3 in.

**VERSA-BASE Sheet:** Starting at the low point of the roof, install 1 layer of TAMKO VERSA-BASE beginning with a 1/2 m width, then a full 1 m width, side lapped 2 in. and end lapped 4 in. Apply at a right angle to the slope of the roof. Solid mop to the insulation with approximately 23 lbs. (±15%) of specification asphalt per 100 sq. ft.

**AWAFLX:** Starting at the low point of the roof, install 1 layer of TAMKO AWAFLX granule surfaced sheet, side lapped 3 in. and end lapped 6 in. The AWAFLX should be solidly adhered to the ply sheet (pressed into the hot asphalt) with approximately 23 lbs. (±15%) of specification asphalt per 100 sq. ft. The asphalt should be above 400° F at the point of application and mopped no more than 4 ft. in front of the roll.

**Flashing:** The flashing material must be a TAMKO polyester reinforced modified asphalt flashing material.

**U.L. Requirements:** Contact TAMKO for information on U.L. systems requirements.

**CAUTION:** The National Institute for Occupational Safety and Health (NIOSH) has concluded that fumes of heated asphalt are a potential occupational carcinogen. Apply heat to these products only when required for proper application and only in a well ventilated area. Avoid breathing the fumes, and avoid skin contact. Do not burn these products.

28.2 AWAFLX  
(HOT ASPHALT APPLIED)

**1013 AWAFLEX**

NAILABLE DECKS (GYPSUM, PRECAST\* AND LIGHTWEIGHT INSULATING CONCRETE)

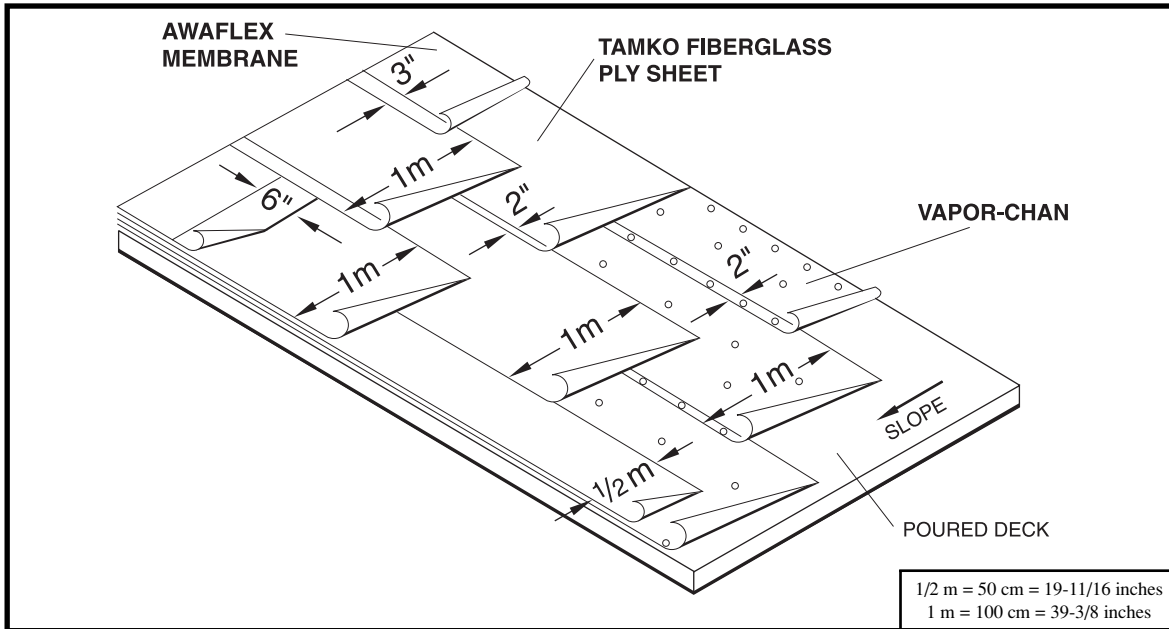

28.2 AWAFLEX (HOT ASPHALT APPLIED)

**Material Requirements**

<b>TAMKO VAPOR-CHAN<sup>®</sup></b> Fiberglass Venting Asphalt Base Sheet	<b>1 ply</b>
<b>TAMKO TAM-PLY IV<sup>®</sup></b> Fiberglass Ply Sheet	<b>1 ply</b>
<b>TAMKO AWAFLEX<sup>®</sup></b> (Granule Surfaced)	<b>1 ply</b>
<b>Asphalt (Per 100 sq. ft.)</b>	<b>Approx. 46 lbs.</b>
<b>Clinch-type nails</b> for base sheet (per 100 sq. ft.)	<b>Approx. 100 nails</b>

**Slope:** Positive drainage up to 3 in. per linear ft. **For slopes above 3/4 in. per linear ft.,** fastening of the AWAFLEX membrane is required.

**Deck:** The deck should conform to TAMKO general requirements.

**Asphalt:** The asphalt should be certified by the manufacturer to meet ASTM D-312, **Type III for slopes up to 1/4 in.** and **Type IV for slopes up to 3 in.**

**VAPOR-CHAN:** Starting at the low point of the roof, install 1 ply of TAMKO VAPOR-CHAN, side lapped 2 in. and end lapped 4 in. Apply at a right angle to the slope of the roof. Nail the sheets along the lap at intervals of no more than 8 in. Stagger-nail down the center of the sheet on 16 in. centers along 2 lines located 12 in. from each edge of the base sheet. **For specific fastening patterns for wind uplift listings, contact the Technical Services Department.**

**Fiberglass Ply Sheet:** Starting at the low point of the roof, install a 1/2 m width, then a full 1 m width of TAM-PLY IV, side-lapped 2 in. and end lapped 4 in. Apply at a right angle to the slope of the roof. Solid mop to the base ply with approximately 23 lbs. (±15%) of specification asphalt.

**AWAFLEX:** Starting at the low point of the roof, install 1 layer of TAMKO AWAFLEX granule surfaced sheet, side lapped 3 in. and end lapped 6 in. The AWAFLEX should be solidly adhered to the ply sheet (pressed into the hot asphalt) with approximately 23 lbs. (±15%) of specification asphalt per 100 sq. ft. The asphalt should be above 400° F at the point of application and mopped no more than 4 ft. in front of the roll.

**Flashing:** The flashing material **must** be a TAMKO polyester reinforced modified asphalt flashing material.

**U.L. Requirements:**  
Contact TAMKO for information on U.L. systems requirements.

**CAUTION:** The National Institute for Occupational Safety and Health (NIOSH) has concluded that fumes of heated asphalt are a potential occupational carcinogen. Apply heat to these products only when required for proper application and only in a well ventilated area. Avoid breathing the fumes, and avoid skin contact. Do not burn these products.

\*Precast Concrete Decks: This specification may be utilized over a precast concrete deck when joints are taped and the VAPOR-CHAN is installed in spot moppings of specification asphalt on (not to exceed) 24 in. centers.

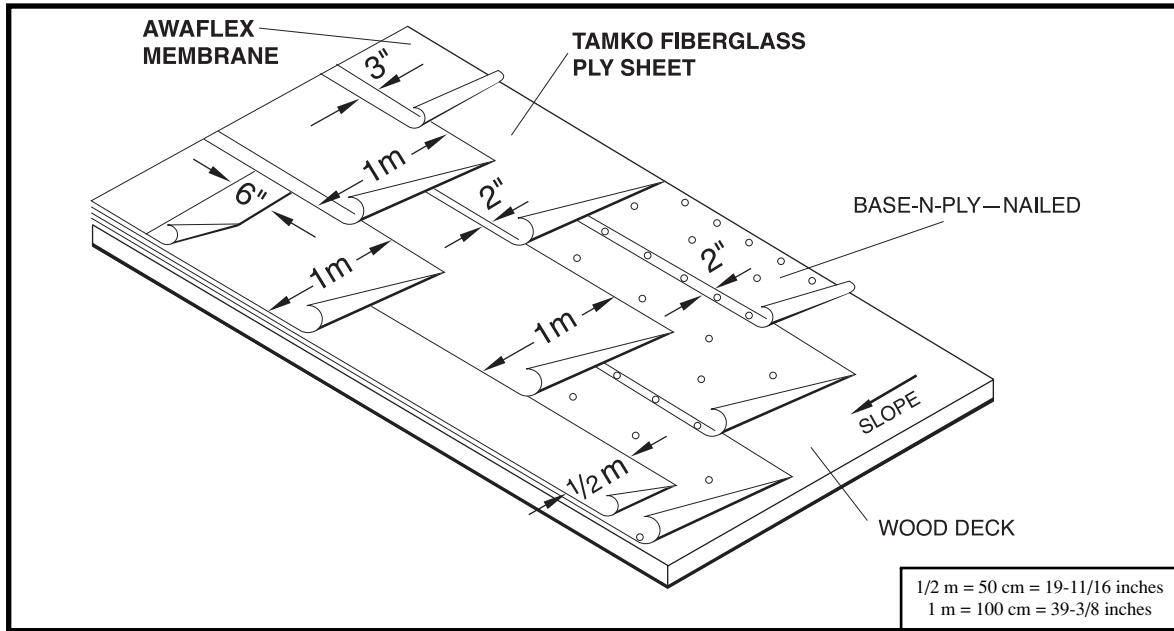

**28.2 AWAFLEX  
(HOT ASPHALT APPLIED)**

**Material Requirements**

<b>TAMKO BASE-N-PLY®</b> Base Sheet	<b>1 ply</b>
<b>TAMKO TAM-PLY IV®</b> Fiberglass Ply Sheet	<b>1 ply</b>
<b>TAMKO AWAFLEX®</b> (Granule Surfaced)	<b>1 ply</b>
<b>Asphalt (Per 100 sq. ft.)</b>	<b>Approx. 46 lbs.</b>
<b>Clinch-type nails</b> for base sheet (per 100 sq ft.)	<b>Approx. 100 nails</b>

**Slope:** Positive drainage up to 3 in. per linear ft. **For slopes above 3/4 in. per linear ft.,** fastening of the AWAFLEX membrane is required.

**Deck:** The deck should conform to TAMKO general requirements.

**Asphalt:** The asphalt should be certified by the manufacturer to meet ASTM D-312, **Type III for slopes up to 1/4 in.** and **Type IV for slopes up to 3 in.**

**Base Sheet:** Starting at the low point of the roof, install 1 ply of TAMKO BASE-N-PLY, side lapped 2 in. and end lapped 4 in. Apply at a right angle to the slope of the roof. Nail the sheets along the lap at intervals of no more than 8 in. Stagger-nail on 16 in. centers along 2 lines located 12 in. from each edge of the base sheet. **For specific fastening patterns for wind uplift listings, contact the Technical Services Department.**

**Fiberglass Ply Sheet:** Starting at the low point of the roof, install a 1/2 m width, then a full 1 m width of TAM-PLY IV, side-lapped 2 in. and end lapped 4 in. Apply at a right angle to the slope of the roof. Solid mop to the base ply with approximately 23 lbs. (±15%) of specification asphalt.

**AWAFLEX:** Starting at the low point of the roof, install 1 layer of TAMKO AWAFLEX granule surfaced sheet, side lapped 3 in. and end lapped 6 in. The AWAFLEX should be solidly adhered to the ply sheet (pressed into the hot asphalt) with approximately 23 lbs. (±15%) of specification asphalt per 100 sq. ft. The asphalt should be above 400° F at the point of application and mopped no more than 4 ft. in front of the roll.

**Flashing:** The flashing material **must** be a TAMKO polyester reinforced modified asphalt flashing material.

**U.L. Requirements:**  
Contact TAMKO for information on U.L. systems requirements.

**CAUTION:** The National Institute for Occupational Safety and Health (NIOSH) has concluded that fumes of heated asphalt are a potential occupational carcinogen. Apply heat to these products only when required for proper application and only in a well ventilated area. Avoid breathing the fumes, and avoid skin contact. Do not burn these products.

**\*Precast Concrete Decks:** This specification may be utilized over a precast concrete deck when joints are taped and the VAPOR-CHAN is installed in spot moppings of specification asphalt on (not to exceed) 24 in. centers.

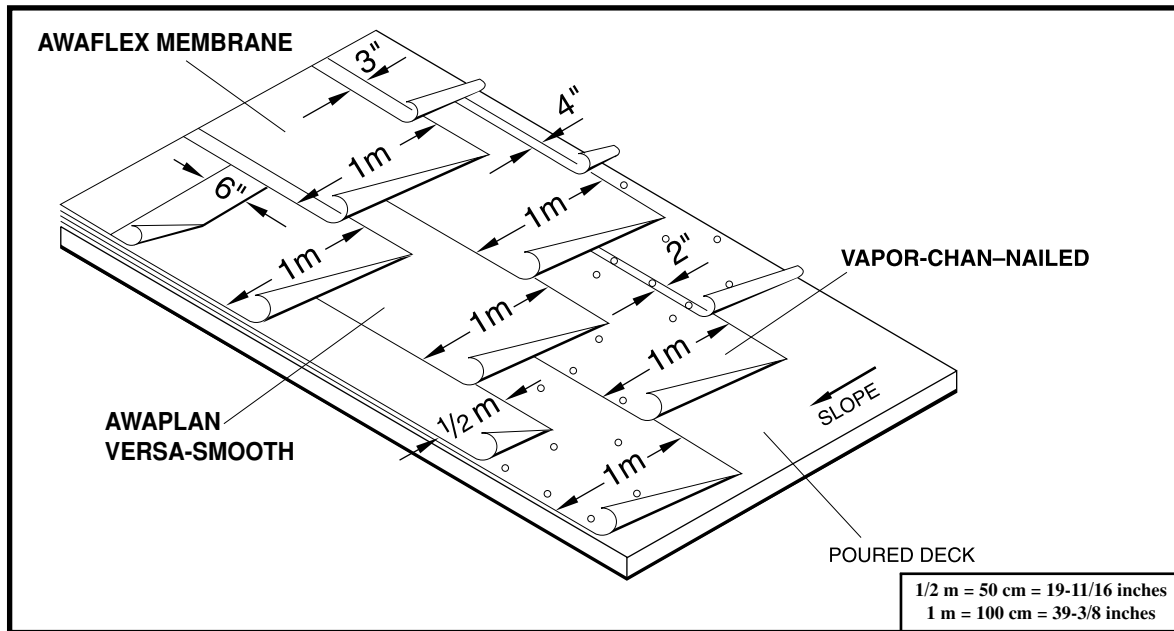

28.2 AWAFLEX (HOT ASPHALT APPLIED)

**Material Requirements**

TAMKO VAPOR-CHAN® Fiberglass Base Sheet	1 ply
TAMKO AWAPLAN VERSA-SMOOTH® Modified Base Sheet	1 ply
TAMKO AWAFLEX (Granule Surfaced)	1 ply
Asphalt (Per 100 sq. ft.)	Approx. 46 lbs.

**Slope:** Positive drainage up to 3 in. per linear ft. For slopes above 3/4 in. per linear ft., fastening of the AWAFLEX is required.

**Deck:** The deck should conform to TAMKO general requirements.

**Asphalt:** The asphalt should be certified by the manufacturer to meet ASTM D-312, Type III for slopes up to 1/4 in. and Type IV for slopes up to 3 in.

**VAPOR-CHAN:** Starting at the low point of the roof, install 1 ply of TAMKO VAPOR-CHAN, side lapped 2 in. and end lapped 4 in. Apply at a right angle to the slope of the roof. Nail the sheets along the lap at intervals of no more than 8 in. Stagger-nail down the center of the sheet on 16 in. centers along 2 lines located 13 in. from each edge of the base sheet. For specific fastening patterns for wind uplift listings, contact the Technical Services Department.

**AWAPLAN VERSA-SMOOTH:** Starting at the low point of the roof, install 1 ply of TAMKO AWAPLAN VERSA-SMOOTH, beginning with a 1/2 m width, then a full 1 m width, side lapped 4 in. and end lapped 6 in. Apply at a right angle to the slope of the roof. The AWAPLAN VERSA-SMOOTH should be solidly adhered to the base sheet (pressed into the hot asphalt) with approximately 23 lbs. (±15%) of specification asphalt per 100 sq. ft. The asphalt

should be above 400° F at the point of application and mopped no more than 4 ft. in front of the roll.

Alternately, the AWAPLAN VERSA-SMOOTH can be heat welded and should be solidly adhered to the base sheet by sufficiently heating the back side with a torch at the juncture of the base sheet and the AWAPLAN VERSA-SMOOTH roll to form a bead of melted asphalt as the AWAPLAN VERSA-SMOOTH is rolled out.

**AWAFLEX:** Starting at the low point of the roof, install 1 layer of TAMKO AWAFLEX granule surfaced sheet, side lapped 3 in. and end lapped 6 in. The AWAFLEX should be solidly adhered to the ply sheet (pressed into the hot asphalt) with approximately 23 lbs. (±15%) of specification asphalt per 100 sq. ft. The asphalt should be above 400° F at the point of application and mopped no more than 4 ft. in front of the roll.

**Flashing:** The flashing material **must** be a TAMKO polyester reinforced modified asphalt flashing material.

**U.L. Requirements:**

Contact TAMKO for information on U.L. systems requirements.

**CAUTION:** The National Institute for Occupational Safety and Health (NIOSH) has concluded that fumes of heated asphalt are a potential occupational carcinogen. Apply heat to these products only when required for proper application and only in a well ventilated area. Avoid breathing the fumes, and avoid skin contact. Do not burn these products.

\*Precast Concrete Decks: This specification may be utilized over a precast concrete deck when joints are taped and the VAPOR-CHAN is installed in spot moppings of specification asphalt on (not to exceed) 24 in. centers.